

# King Quilter Optional Rear Handlebar

## Installation Instructions

09/05/18

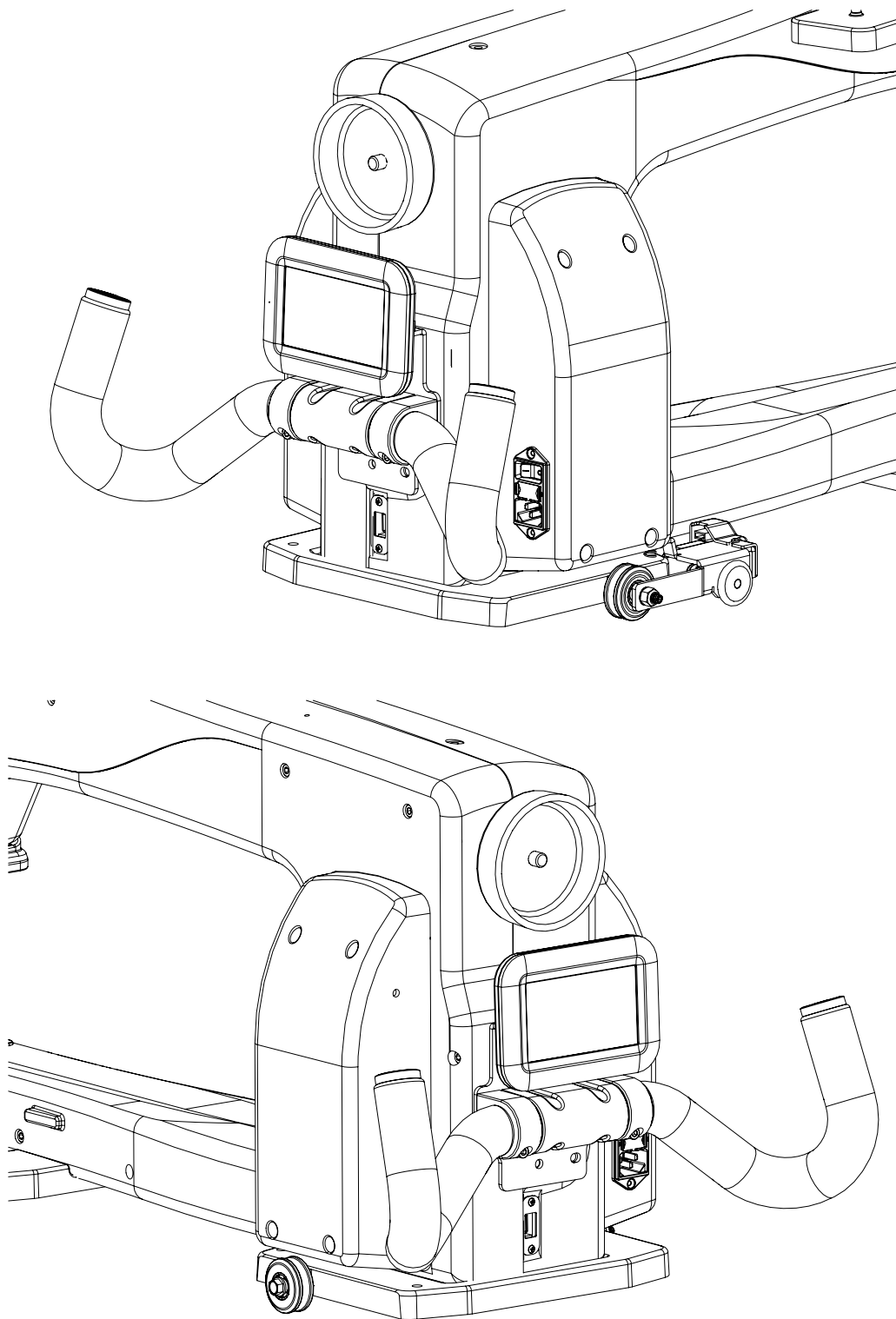

# QM29005 Boxed Optional Rear Handlebar

## Package Contents:

- 1 qty QM29304 Optional Rear Handlebar Assembly with 4.3" display mounted to handlebar
- 2 qty QM10955 Screw, M6x16 SKB SS, bagged and wrapped on handle
- 1 qty QM23010 Cable, display to handlebar
- 1 qty QM23011 Cable, handlebar to machine

 Note: These instructions explain how to install the optional rear handlebar. For optional rear handlebar functionality, please see the machine user manual.

## Installing Optional Rear Handlebar

△ **CAUTION:** Unplug the King Quilter from the electrical outlet. All power to the machine must be turned off when installing the rear handles. Failure to do so can result in damage to the machine and or the handlebar.

1. Line up the two holes in the handlebar bracket with those on the rear of the machine. Slide the short bolts into holes until they stop. Hand tighten, and then use the 4mm wrench (included with the machine accessories) to securely fasten the handles to the back of the machine.
2. Once the two bolts are in place, plug the large USB connector into the large USB connection jack located at the rear of the machine.
3. The display will come pre-assembled to the handlebar assembly with two hinges with two screws each.
4. Connect the small QM23010 cable from the top of the handlebar to the display. Connect the large QM23011 USB cable from the bottom of the handlebar to the machine.

✎ **IMPORTANT NOTE:** the display has a large USB connection on the bottom for updating the machine or display. This USB connector is not used to connect the display to the handlebar or the display to the machine. This USB connector normally has a black plug. This is to deter the user from using this connection to plug the handlebar into the machine. The black plug is removed to update the display or machine.





## Optional Rear Handlebar Connections



QM23010 Top cable: display to handlebar cable, mini USB 90 degree to mini USB 90 degree.



QM23011 bottom cable: handlebar to machine cable, large USB connection, 90 degree to right angle.



For optional rear handlebar functionality, please see the machine user manual.

### Troubleshooting

After the handlebar has been completely installed and plugged in, test by turning the King Quilter on/off switch to "on". If nothing is displayed, check that the handlebar cable on the back of the machine is plugged in securely, that your machine is turned on, and that the power cord is plugged into the machine as well as a power source.

