

# SUPER JEANS®

# TOYOTA SPJ17XL

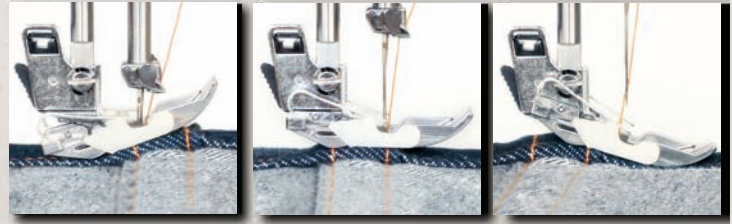

**GLIDE OVER 12 LAYERS**

**FOR PROFESSIONAL FINISH  
FROM A DOMESTIC MACHINE**

**NEW**

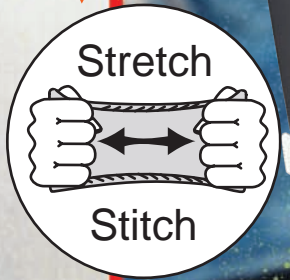

**LIGHT WEIGHT (4.9 KG) EASILY PORTABLE**

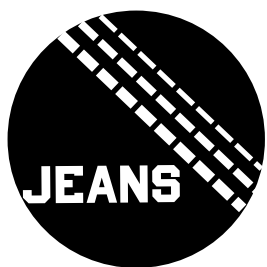

**THICK THREAD  
SEWING CAPABILITY**

\* Only applicable to  
SPJ17XL



+



+



[www.home-sewing.com](http://www.home-sewing.com)

**JAPANESE TECHNOLOGY**





# SUPER JEANS

# TOYOTA SPJ17XL



## Glide over 12 layers

The Gliding Foot is especially designed to sew extra thick Jeans hem and other thick fabrics

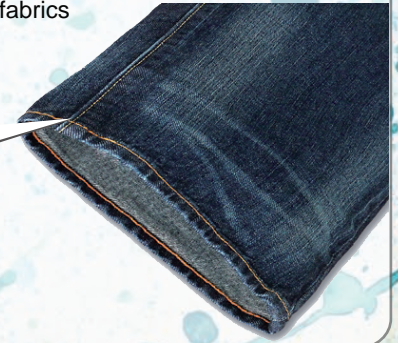
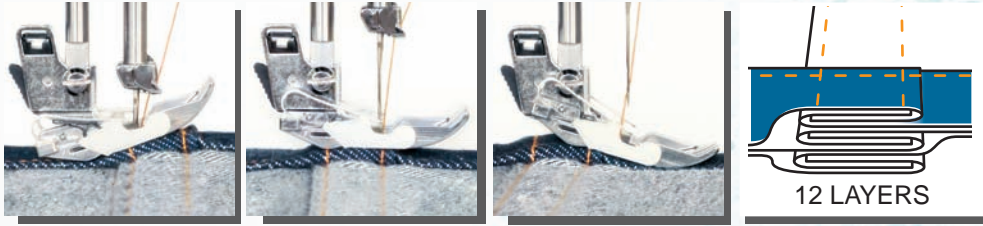

## Ergonomic Design for Easy Sewing

1. Easy to see needle drop point
2. Easy to use large dials, levers and wide sewing area
3. Top loading rotary system with see through cover



## Built-in Quick Adviser

- How to thread the machine ?
- How to put the bobbin in ?
- Trouble shooting to wind the bobbin
- Trouble shooting for stitch problem



## Built-in needle threader Main power switch



Easy to operate

Safety and Energy Saving



## 17 Multi-purpose programmes

### 13 standard stitch programmes

1 2 4 3 5 6 7 8 9 10 11 12 16



- 1-2-3-4. 4 step buttonhole
- 5-6. Zigzag stitch, overcasting
- 7-8. Straight stitch (small, medium)
- 9. Straight stitch (left side)
- 10-11. Overcasting stitch
- 12. Blind hem stitch
- 16. Mending stitch, thin fabric overcasting

### 2 stretch

13 14



- 13. Reinforced straight stitch
- 14. Stretch stitch, overlock

### 2 deco

15 17



- 15-17. Decorative stitches



### Standard accessories

- \*Standard needle (x 2)
- \*Jeans needle (x 2)
- \*Ball point needle (x 1)
- \*Gliding foot
- \*Zigzag foot
- \*Overcasting foot
- \*Zipper foot
- \*Blind hem foot
- \*Buttonhole foot, 4 step
- \*Plastic bobbin (x 2)
- \*Spool cap
- \*Buttonhole cutter
- \*Sewing guide
- \*Needle plate screw drive

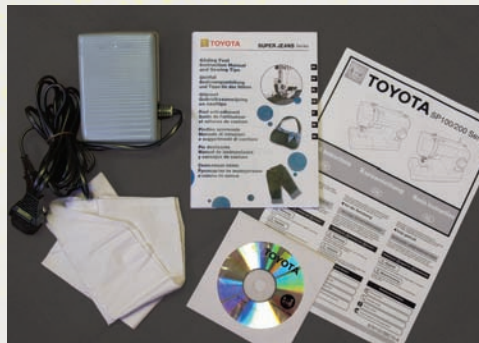

### Other included accessories

- \*Dust cover
- \*Electronic foot controller
- \*Quick guide instruction manual
- \*Manual CD
- \*Gliding foot instruction manual and sewing tips

## SPECIFICATIONS

- Maximum stitch length : 4mm
- Maximum stitch width : 5mm
- Needle position : center / left
- Net weight : 4,9kg
- Sewing machine size : 410 x 198 x 294 mm
- Rated voltage : 220-240V
- Rated frequency : 50 Hz
- Rated power : 65 W
- Light bulb : 15 W
- Series : SP100